



VILLAGE DRY CLEANERS

@villagedrycleaners villagedrycleaners.com 0161 860 4451

OPEN

Opening Hours

Monday 9:00 - 12:00
Tuesday 9:00 - 12:00
Wednesday 9:00 - 12:00
Thursday 9:00 - 12:00
Friday 9:00 - 12:00
Saturday 9:00 - 12:00
Sunday Closed

Wedding Dress Special

CUSTOMER
PARKING

jordanfishwick

Manchester Road
Chorlton



Manchester Road Chorlton M21 9PH

£1,500 Per Calendar Month



The Property

***** AVAILABLE NOW ***** A stunning and spacious first floor apartment located in the heart of Chorlton boasting three double bedrooms beautifully presented throughout. Located only a short walk to Chorlton village and the Metrolink, this apartment will prove ideal for a family or professional couple. The spacious accommodation is split over two floors and briefly comprises: private entrance & hallway, fitted kitchen with all appliances, lounge, three excellently proportioned double bedrooms and large stunning bathroom including bath and separate walk-in shower. The first floor has the Lounge, Kitchen/dining room with balcony, one double bedroom and lounge, to the second floor are two further bedrooms. The property has been stylishly decorated and furnished throughout and exciting and original property. Fully double glazed and insulated, with thermostatically controlled efficient gas central heating. Property is fully furnished. NOT SUITABLE FOR MULTIPLE SHARERS.

***** To arrange a viewing please call 0161 9393 7539 *****

Directions

- Council Tax Band B - EPC - B
- 3 Double Bedrooms
- Duplex Apartment
- Central Chorlton Location
- Furnished
- Private Balcony
- Available Now

Postcode - M21 9PH

EPC Rating - B

Floor Area - sq ft

Local Authority - Manchester

Council Tax - B



GROUND FLOOR
111 sq.ft. (10.2 sq.m.) approx.



FIRST FLOOR
703 sq.ft. (65.3 sq.m.) approx.



1ST FLOOR
308 sq.ft. (28.4 sq.m.) approx.

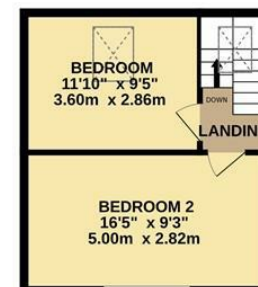

TOTAL FLOOR AREA : 1120 sq.ft. (104.1 sq.m.) approx.
Measurements are approximate. Not to scale. Illustrative purposes only.
Made with Metropix ©2025



These particulars are believed to be accurate but they are not guaranteed and do not form a contract. Neither Jordan Fishwick nor the vendor or lessor accept any responsibility in respect of these particulars, which are not intended to be statements or representations of fact and any intending purchaser or lessee must satisfy himself by inspection or otherwise as to the correctness of each of the statements contained in these particulars. Any floorplans on this brochure are for illustrative purposes only and are not necessarily to scale.

Offices at: Offices at Chorlton, Didsbury, Disley, Hale, Glossop, Macclesfield, Manchester Deansgate, Manchester Whitworth Street, New Mills, Sale, Wilmslow and Withington

410-412 Barlow Moor Road, Chorlton, Manchester, M21
8AD

www.jordanfishwick.co.uk